

# 1968-81 Major Repair Kit Installation (SH005N, SH005P)

1. Unscrew knob.
2. Lift off lock-out rod spring.
3. Remove T-handle  
(lock out rod should come with handle)
4. Remove retainer #12
5. Pull out shaft #9
6. Pull bracket #13 apart  
(containing levers #14-17)
7. Remove retainer #11
8. Pull out pin #10
9. Shaft #6 will slide out the bottom of  
bracket #18
10. Clean all parts with solvent
11. Check all parts not supplied in kit for  
cracks, excessive wear, etc. Normally  
these parts are useable. However if  
there is a defect found, the part can be  
bought at your Corvette dealer.
12. Lubricate levers #14, #16, #17 and  
new interlock #15 with white grease.  
If levers are loose side to side, use  
thicker interlock. If not loose use thinner  
interlock.
13. Lubricate inside of bracket #13; install  
levers with interlock in bracket #13 in  
proper order (as in drawing)
14. Lubricate shaft #6 and bracket #18  
at pivot points; also lubricate new  
shaft #9 and pin #10
15. Slide shaft #6 up through bracket #18
16. Install pin #10 and retainer #11
17. Install bracket #13 into bracket #18 with  
shaft #6 falling on the left side of the  
interlock #15 (when looking from  
the back of shifter)
18. Install shaft #9 and retainer #12
19. Lubricate lock-out rod #7
20. Install T-handle with lock-out rod  
& spring #4, #7, #2
21. Screw knob #1 onto shaft #6

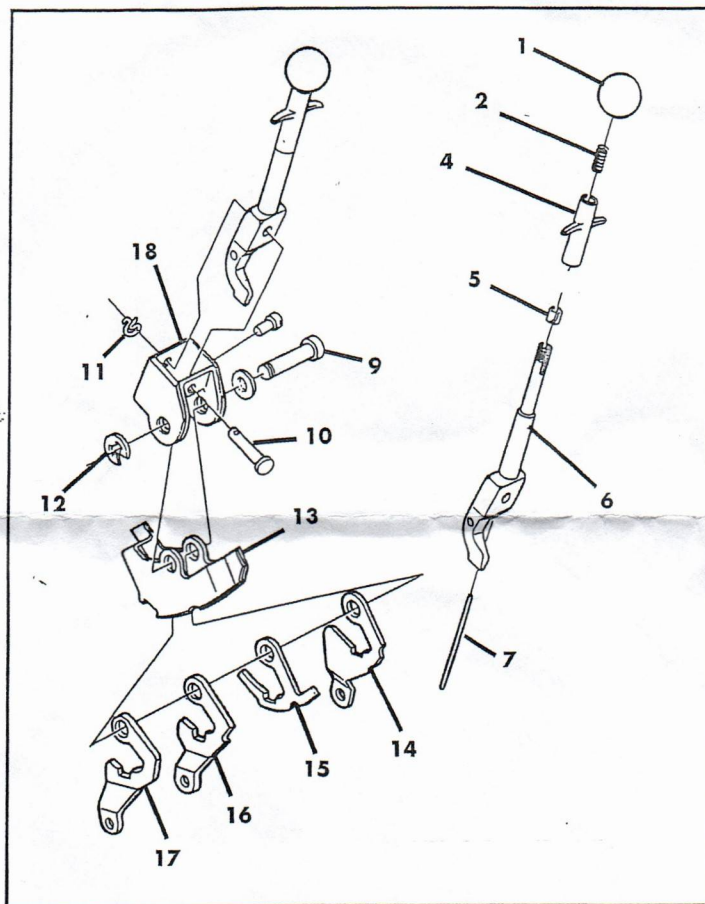

## Parts List:

### SH005N Repair kit (Major) 1968-76

- SH016 SHIFTER KNOB (3&4 SPEED) BLACK
- SH019 SHIFTER LOCK OUT SPRING (3&4 SPEED)
- SH023 HANDLE WITH LOCKOUT ROD
- SH029 SHIFTER CONTROL LEVER PIN LOWER
- SH030 SHIFTER CONTROL LEVER LIN LOWER RETAINER
- SH032 SHIFTER CONTROL LEVER SHAFT
- SH033 SHIFTER LOWER SHAFT RETAINER
- SH037 SHIFTER REVERSE LEVER INTERLOCK (THIN 5/64)
- SH037A SHIFTER REVERSE LEVER INTERLOCK (THICK 7/64)

### SH005P Repair kit (Major) 1977-81

- SH016 SHIFTER KNOB (3&4 SPEED) BLACK
- SH019 SHIFTER LOCK OUT SPRING (3&4 SPEED)
- SH024 HANDLE WITH LOCKOUT ROD
- SH029 SHIFTER CONTROL LEVER PIN LOWER
- SH030 SHIFTER CONTROL LEVER LIN LOWER RETAINER
- SH032 SHIFTER CONTROL LEVER SHAFT
- SH033 SHIFTER LOWER SHAFT RETAINER
- SH037 SHIFTER REVERSE LEVER INTERLOCK (THIN 5/64)
- SH037A SHIFTER REVERSE LEVER INTERLOCK (THICK 7/64)